

Features of LF-SEAL

Lubrication of porous resin containing lubricant improves economic efficiency by extending the grease interval

- Always supply new lubricant to the raceway
- **Prevent** foreign substances by minimizing clearance with raceway

RM5N+LF : High speed durability test

○ No harmful detect even after running 300 million cycle test.

Test Condition	
Products	RM5N+LF
Stroke	8 mm
RPM	116[min^{-1}]
Maximum Accelerati	12.0G
Grease Usage	None

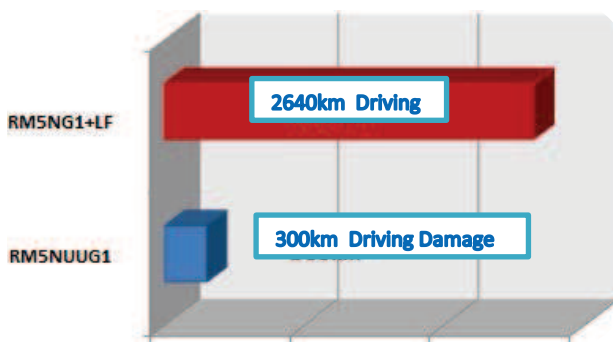

RBS15R+LF : Lubricating performance test

○ No harmful detect even when running 192 times more than the basic type(without LF seal)

Test Condition	
Products	RBS15RLFG1
Pre-load	0.05C(G1)
Stroke	350mm
Test Speed	1 m/s
Grease Usage	None

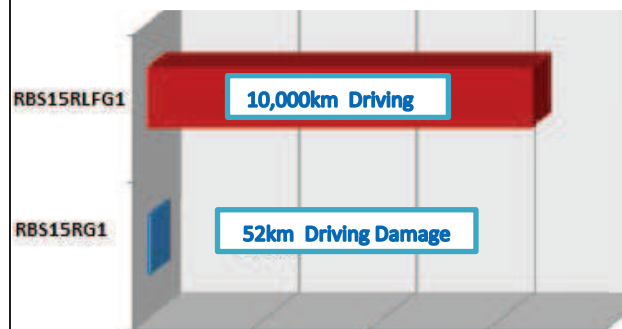
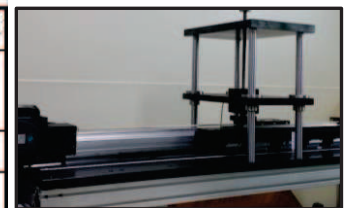



LUBRICATION SEAL

Ordering (LF-SEAL)

Model No.	5	7	9	12	15	20	25	30	35	45	55
RBH	-	-	-	-	○	○	○	○	○	○	-
RBS	-	-	-	-	○	○	○	-	-	-	-
RM	○	○	○	○	○	○	-	-	-	-	-
RMB	○	○	○	○	○	-	-	-	-	-	-
RMBT	-	-	-	○	○	-	-	-	-	-	-

Composition

RBH25 S FL SS LF 2 G1 - 1000L 20/40 P A T F - 2

① ② ③ ④ ⑤ ⑥ ⑦ ⑧ ⑨ ⑩ ⑪ ⑫ ⑬ ⑭

① Model No. of Linear Motion Guide

② Type of block : No Symbol - Full ball type/ S - Spacer retainer type

③ Form of block: R - Rectangular standard type/ RL - Rectangular long type/ F - Flange type

④ Type of seal: UU-End seal / SS-End seal +Inside seal / ZZ-End seal +Inside seal + metal scraper

⑤ LF-SEAL

⑥ Number of blocks combined in 1 rail

⑦ Symbol of Clearance: No symbol-Normal preload/ G1-Light preload/ G2-Heavy preload/ G3-Special preload

⑧ Length of rail

⑨ Size of G value: standard G value has no symbol

⑩ Symbol of precision: No symbol-Moderate precision/ H-High

⑪ No symbol-Rail counter bore type(A topside assembly)/ A-Rail tap hole type(an underside assembly)

⑫ Connection symbol

⑬ Special symbol F-Raydent

⑭ Number of axis used on the same surface

Applied table with LF-SEAL

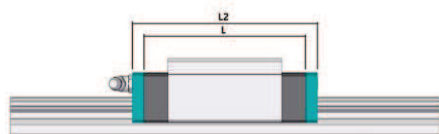

RBH15-45 applied table with LF seal (RBH15-45 table) Unit : mm

Model No.		before LF seal	after LF seal
Standard Type	Long Type	L	L2
RBH15	-	57.0	69.0
-	RBH15*L	65.3	77.3
RBH20	-	72.7	84.7
-	RBH20*L	88.6	100.6
RBH25	-	83.0	95.0
-	RBH25*L	102.9	114.9
RBH30	-	97.8	111.8
-	RBH30*L	120.0	134.0
RBH35	-	110.0	124.0
-	RBH35*L	135.4	149.4
RBH45	-	139.0	154.0
-	RBH45*L	170.8	185.8

RBS15-25 applied table with LF seal Unit : mm

Model No.		before LF seal	after LF seal
Short Type	Standard Type	L	L2
RBS15C*	-	40.2	52.2
-	RBS15*	56.9	68.9
RBS20C*	-	47.2	59.2
-	RBS20*	66.3	78.3
RBS25C*	-	59.1	71.1
-	RBS25*	83.0	95.0

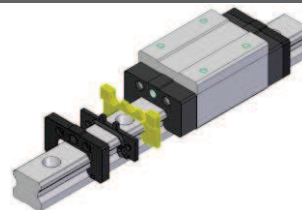

RM5-20 Applied table with LF seal (RM5-20) Unit : mm

Model No.			before LF seal	after LF seal
Short Type	Standard Type	Long Type	L	L2
RM5C	-	-	17.0	21.4
-	RM5N	-	20.0	24.4
RM7C	-	-	19.8	24.8
-	RM7N	-	24.3	29.3
-	-	RM7L	31.8	36.8
RM9C	-	-	22.4	27.4
-	RM9N	-	31.3	36.3
-	-	RM9L	41.4	46.4
RM12C	-	-	26.4	32.4
-	RM12N	-	34.9	40.9
-	-	RM12L	45.4	51.4
RM15C	-	-	34.4	41.4
-	RM15N	-	44.4	51.4
-	-	RM15L	59.4	66.4
RM20C	-	-	39.8	46.8
-	RM20N	-	51.8	58.8
-	-	RM20L	69.8	76.8

※ LF-SEAL General Precautions

1. Use within the maximum operating temperature of 40 ° C
2. Avoid contact with organic solvents, such as thinner or milky white oil
3. During the initial use of the LF-SEAL, the rolling resistance may increase
4. LF-SEAL (2 EA) should use both sides of each block

RMB5-RMB15 applied table with LF seal (RMB5-RMB15) Unit : mm

Model No.			before LF seal	after LF seal
Short Type	Standard Type	Long Type	L	L2
RMB5C	-	-	21.0	25.4
-	RMB5N	-	25.0	29.4
RMB7C	-	-	24.0	29.0
-	RMB7N	-	33.0	38.0
-	-	RMB7L	43.5	48.5
RMB9C	-	-	28.1	33.1
-	RMB9N	-	40.2	45.2
-	-	RMB9L	52.0	57.0
RMB12C	-	-	31.1	37.1
-	RMB12N	-	44.5	50.5
-	-	RMB12L	59.7	65.7
RMB15C	-	-	42.8	49.8
-	RMB15N	-	56.6	63.6
-	-	RMB15L	75.8	82.8