

ULCO 66

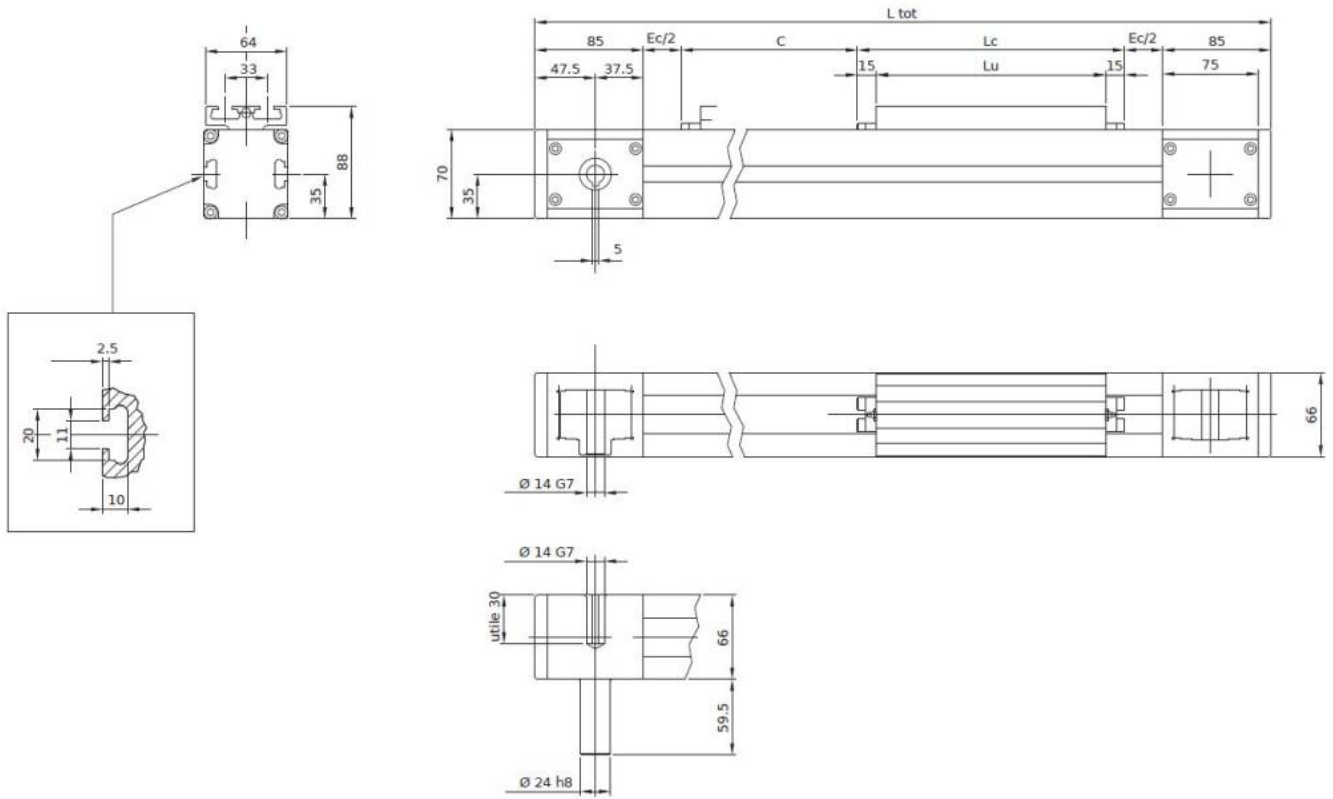

Mechanical Drawing



Load rating

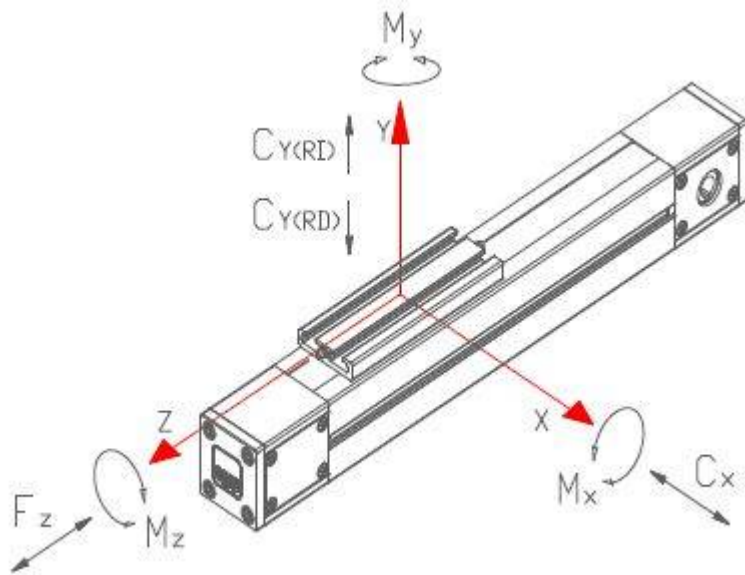

Fz [daN]	Cx [daN]	Cy [daN] (*)	C _{ox} [daN]	C _{oy} [daN] (*)	M _{ox} [daNm]	M _{oy} [daNm]	M _{oz} [daNm]
220	1904	1904↓ 1904↑	3091	3091↓ 3091↑	253	253	20,2

Technical Data

Parameter	Symbol	Value	Unit
Max usable stroke		6500	mm

Total lenght	Ltot	C+Lc+230	mm
Carriage length	Lc	250	mm
Carriage usable length	Lu	220	mm
Extra-stroke (safety)	Ec	60	mm
Max speed		250	m/min
Max acceleration		100	m/sec ²
Position repeatability		< 0.05	mm
Aluminium profile section		66 x 70	mm
Inertia momentum of aluminium profile	Ix	944288	mm ⁴
Inertia momentum of aluminium profile	Iy	993457	mm ⁴
Type of mechanic		linear guide with compact block	
Belt type		Poliuretán HTD-5M-34	
Pulley teeth number		36	
Diameter		57,32	mm
Linear movement per rotation		180	mm
Operating temperature		-20 / +60	degrees

From:

<https://www.nilab.at/dokuwiki/> - **NiLAB GmbH**
Knowledgebase

Permanent link:

https://www.nilab.at/dokuwiki/doku.php?id=ulco:ulco_66

Last update: **2025/07/24 13:24**

