

ULCO 88

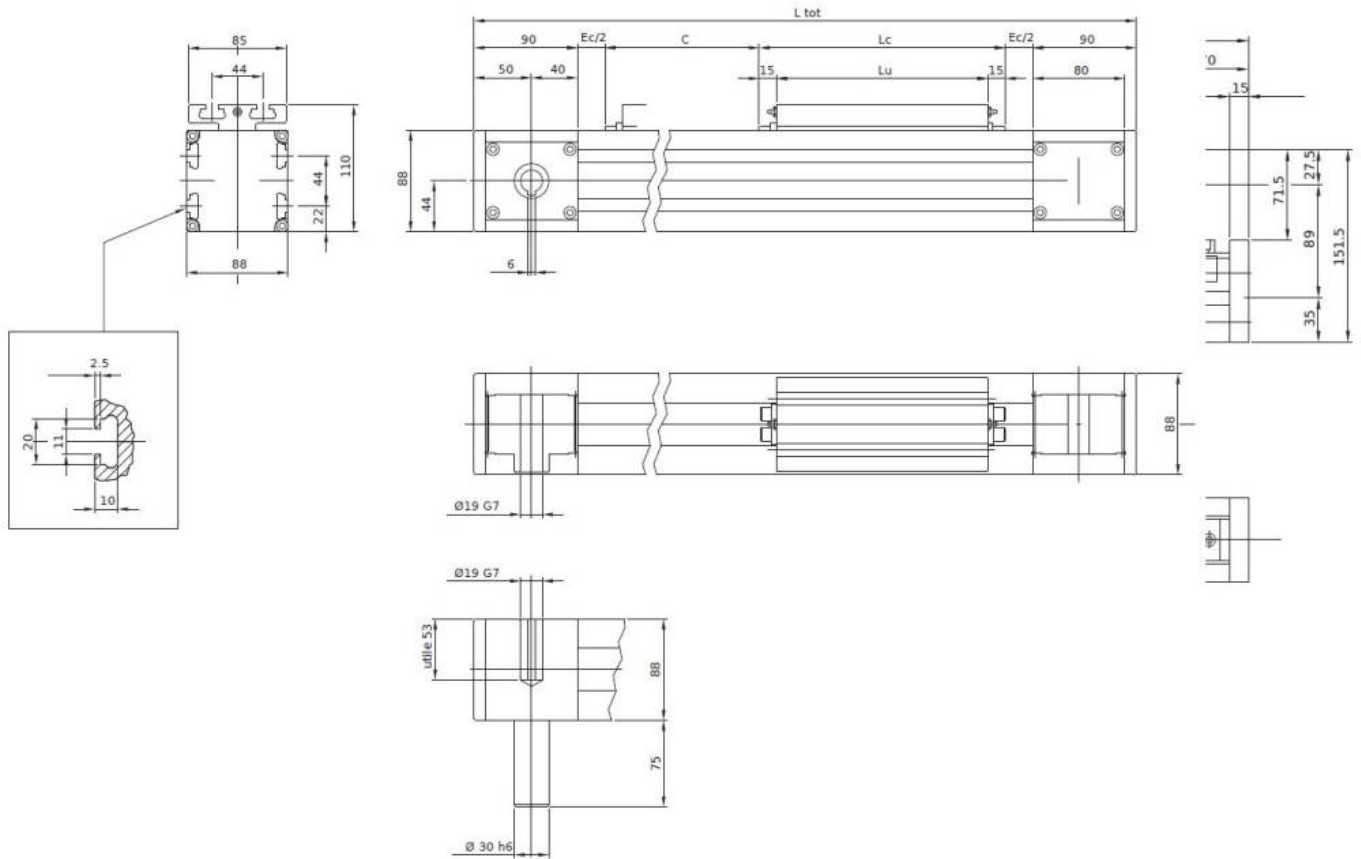

Mechanical drawing



Load rating

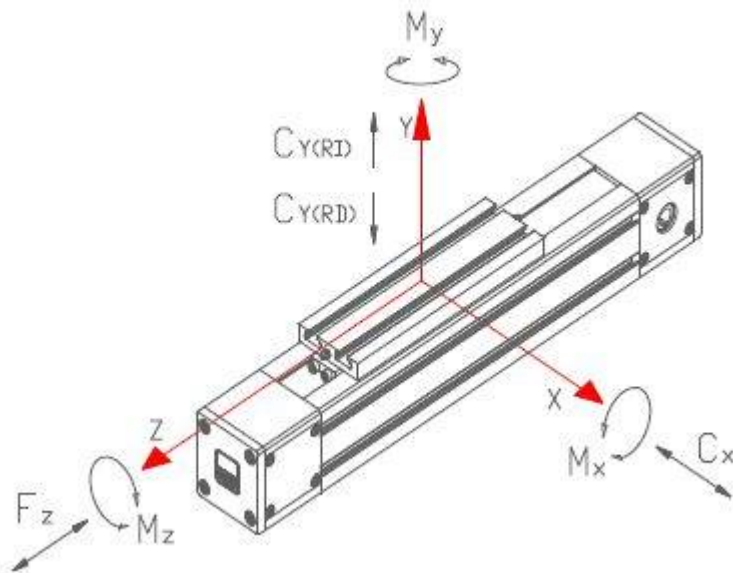

F_z [daN]	C_x [daN]	C_y [daN] (*)	C_{o,x} [daN]	C_{o,y} [daN] (*)	M_{o,x} [daNm]	M_{o,y} [daNm]	M_{o,z} [daNm]
500	4547	4547↓ 4547↑	7862	7862↓ 7862↑	766	766	80

Technical data

Parameter	Symbol	Value	Unit
Max usable stroke		6400	mm
Total lenght	Ltot	C+Lc+240	mm
Carriage length	Lc	300	mm
Carriage usable length	Lu	270	mm
Extra-stroke (safety)	Ec	60	mm
Max speed		250	m/min
Max acceleration		100	m/sec ²
Position repeatability		< 0.05	mm
Aluminium profile section		88 x 88	mm
Inertia momentum of aluminium profile	Ix	2100259	mm ⁴
Inertia momentum of aluminium profile	Iy	2896145	mm ⁴
Type of mechanic		linear guide with compact block	
Belt type		Poliuretan HTD-5M-47	
Pulley teeth number		30	
Diameter		76,43	mm
Linear movement per rotation		240	mm
Operating temperature		-20 / +60	degrees

From:

<https://www.nilab.at/dokuwiki/> - **NiLAB GmbH**
Knowledgebase

Permanent link:

<https://www.nilab.at/dokuwiki/doku.php?id=ulco:ulco88>

Last update: **2025/07/24 13:35**

